

CARTONI
PROFESSIONAL CAMERA SUPPORT



MASTER
40 ✓

USER'S MANUAL
&
MAINTENANCE

CARTONI ® / All rights reserved ©

Manual Version: 1.0

Issue date: May 2019

CARTONI S.p.A

Via di Portonaccio, 33/B - 00159 Rome (Italy)

Phone +39 06 4382002

Fax +39 06 43588293

Email cartoni@cartoni.com

www.cartoni.com



CERTIFICATO N. 19714/09/S

CERTIFICATE No.

SI CERTIFICA CHE IL SISTEMA DI GESTIONE PER LA QUALITÀ DI
IT IS HEREBY CERTIFIED THAT THE QUALITY MANAGEMENT SYSTEM OF

CARTONI S.P.A.

VIA DI PORTONACCIO, 33/B 00159 ROMA (RM) ITALIA

VI A DI PORTONACCIO, 33/B 00159 ROMA (RM) ITALIA

CISQ is a member of



IONet, the association of the world's first class certification bodies, is the largest provider of management system certification in the world. IONet is composed of more than 30 bodies and counts over 300 subsidiaries all over the globe.

Per informazioni sulla validità del certificato, visitate il sito www.rina.it

For information concerning validity of the certificate, you can visit the site www.rina.org

Per i requisiti della norma non applicabili al campo di applicazione del sistema di gestione dell'organizzazione, riferirsi alle informazioni documentarie relative.

Reference is to be made to the relevant documented information for the requirements of the standard that cannot be applied to the Organization's management system scope.

E CONFORME ALLA NORMA / IS IN COMPLIANCE WITH THE STANDARD

ISO 9001:2015

PER I SEGUENTI CAMPI DI ATTIVITÀ / FOR THE FOLLOWING FIELD(S) OF ACTIVITIES

IAF-1 / IAF-75

PROGETTAZIONE, FABBRICAZIONE ED ASSISTENZA POST-VENDITA DI PRODOTTI PER LA CINEMATOGRAFIA E LA TELEVISIONE PROFESSIONALE. COMMERCIALIZZAZIONE DI PRODOTTI ED ACCESSORI IN CONCESSIONE PER LA CINEMATOGRAFIA E LA TELEVISIONE PROFESSIONALE.

DESIGN, MANUFACTURE AND POST-SALE ASSISTANCE OF PROFESSIONAL BROADCAST AND FILM EQUIPMENT. MARKETING OF PROFESSIONAL BROADCAST AND FILM ACCESSORIES AND PRODUCTS AS / OCAI AGENCY/REPRESENTATIVE.

La validità del presente certificato è subordinata a sorveglianza periodica annuale / semestrale ed al riesame completo del sistema di gestione con periodicità triennale.
The validity of this certificate is dependent on an annual / six monthly audit and on a complete review, every three years, of the management system.
The scope and validity of this certificate are subject to compliance with the IONet document / Rules for the certification of Quality Management Systems.

Prima emissione / First issue	12.08.2009	Data decisione di rinnovo / Renewal decision date	24.05.2018
Data scadenza / Expiry date	07.06.2021	Data revisione / Revision date	24.05.2018

Amministratore Rina
Rome Management System
Certification, Head



RINA Services S.p.A.
Via Corsica 12 - 16128 Genova Italy



SGQ N° 002 A



MEMBER OF THE ASSOCIATION OF CERTIFICATION BODIES



FEDERAZIONE CISQ
www.cisq.com

CISQ è la Federazione Italiana di Organismi di Certificazione che aderisce al protocollo europeo. CISQ is the Italian Federation of management system certification bodies.

Index

1. Introduction.....	1
2. Operating elements.....	2
3. Procedures.....	4
4. Specifications.....	5
5. Maintenance.....	5
6. Warranty.....	6
7. Accessories & product line	6

1. Introduction

The MASTER 40 is the ideal support for Broadcast Camera configurations up to 40 kg (88lbs). It features an amazingly smooth patented counterbalance system and the superb thin plates fluid drag.

The MASTER 40 controls, knobs and levers, are ergonomically placed to ensure Camera operators complete ease-of-use in any situation, whether in the studio, location or during outside broadcasts while drag and counterbalance systems are monitored on a digital display.

Payload capacity goes from zero (0) to 40 Kg (88 lbs) with a perfect balance throughout the entire 180° tilt range.

The specifically designed continuous Fluid Drag System performs from almost freewheeling to extremely consistent drag for maximum versatility.

It features a V wedge plate for box lenses interface, installed on a wide sliding platform for perfect centering of the Camera.

Extremely rugged and precise, the MASTER 40 is meant to become the ultimate industry standard.

- Before using the MASTER 40 Fluid Head, please make sure to read this user's & maintenance manual;
- Before installing the Fluid Head on the tripod check the tripod stability;
- Check that the Camera payload (including lenses and accessories) is lower than the maximum capacity of the MASTER 40 Fluid Head;
- Before installing the Camera make sure the MASTER 40 is in good conditions and bares no evident damages.

2. Operating elements

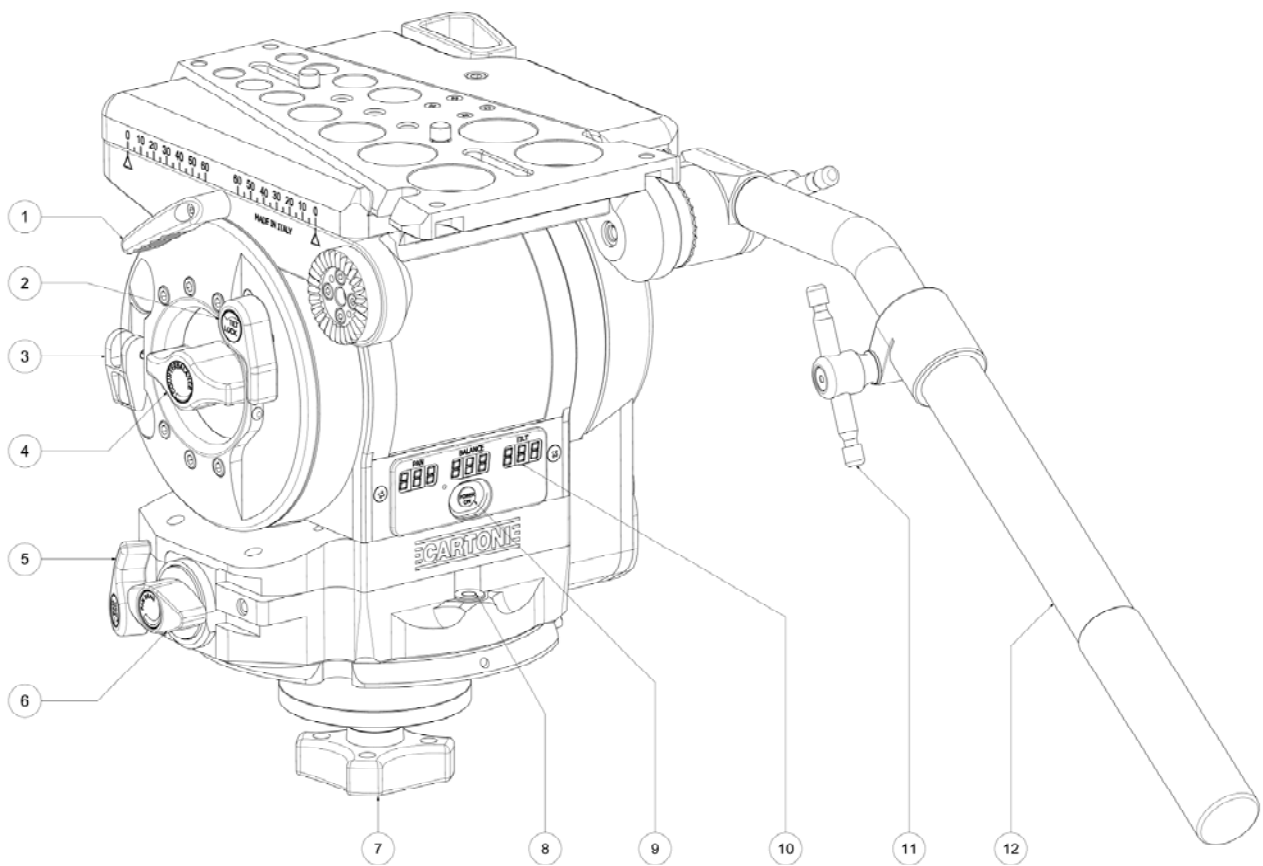

- 1) Sliding plate lock lever
- 2) Tilt lock lever
- 3) Horizontal lock lever
- 4) Counterbalance selector
- 5) Pan lock lever
- 6) Pan drag selector
- 7) Tie down knob
- 8) Illuminated bubble level
- 9) Illuminated bubble level and digital display light button
- 10) Digital display
- 11) Extensible handle attachment lever
- 12) Extensible pan handle

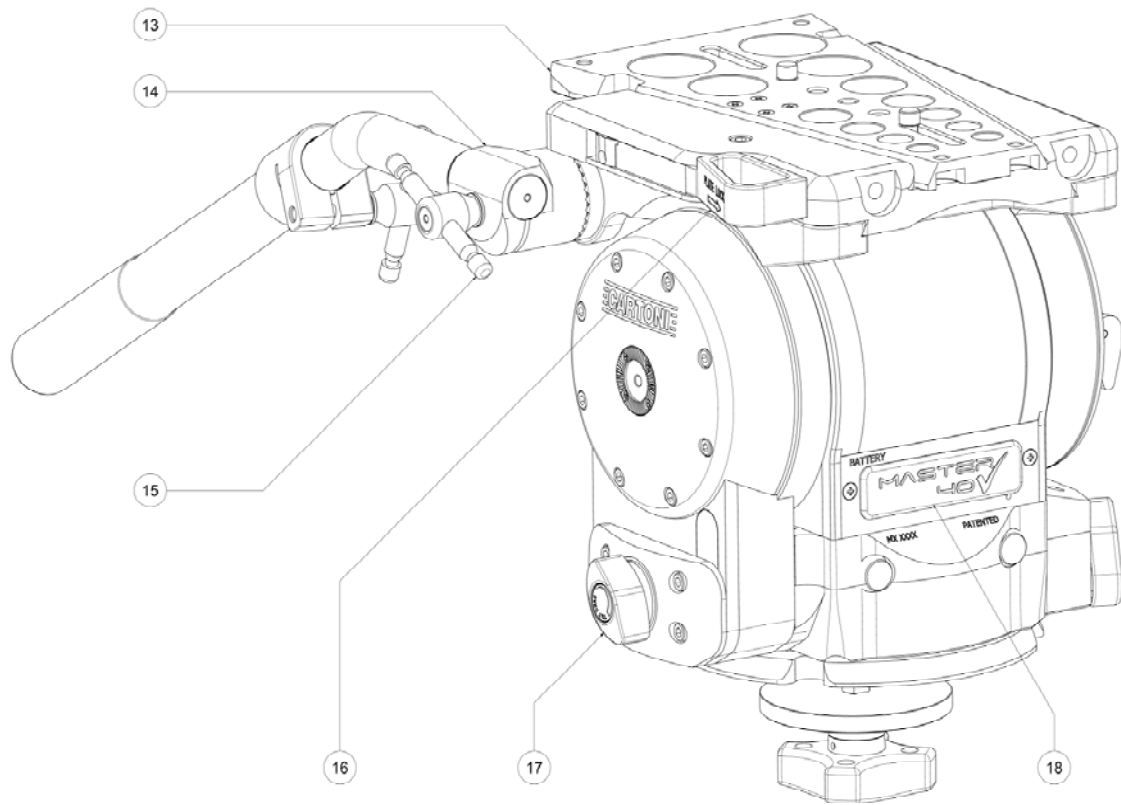

- 13) Camera plate
- 14) Pan bar attachment rosette
- 15) Pan bar attachment lever
- 16) Camera plate lock lever
- 17) Tilt drag selector
- 18) Battery housing

3. Procedures

- Open the tripod to the desired height and lock all the safety knobs.
- Place the MASTER 40 Fluid Head on the tripod base and rotate until it matches the steel notch; tighten the Head firmly by screwing in the knob (7) underneath the flat base. Check the illuminated bubble level (8) and modify the legs angle if needed. In case of low visibility, press button (9) for illuminated bubble level and to activate the digital displays (10). Lights will turn off automatically after approximately 30 seconds.
- Lock the horizontal position with lever (3) red position, insert pan lock (5) and sliding plate lock (1) and turn both tilt drag selector (17) and counterbalance selector (4) to position "0".
- To release the Camera plate (13) slide forward the Camera plate lock lever (16) and rotate it 90° counterclockwise, then remove the Camera plate.
- Attach the Camera plate under the Camera assembly and firmly secure it with both screws. Try to place the Camera plate centered under the Camera system, keeping in mind the position of the center of gravity (CG).
- Place the Camera on the top of the MASTER 40, by pushing the Camera plate (13) forward to perfectly match the sliding plate proper position, then close the Camera plate lock lever (16).
- Holding the pan bar (12) firmly, disengage sliding plate lock (1) and lever (3) to green position and find the correct center of gravity (CG) by sliding the Camera assembly fore-and-aft. Lock the sliding plate with lever (1).
- Set the counterbalance system by turning the counterbalance selector (4) to the appropriate tension. The Camera has to stay still at any tilt angle. If needed, fine tune the balance by adjusting the sliding plate.
- Push button (9) to activate illuminated digital displays (10), unlock Pan lock (5) and select the desired Fluid drag intensity on both Pan and tilt by turning Pan selector (6) and tilt selector (17).

4. Specifications

Minimum payload	0 Kg – 0 lbs
Maximum payload	40 Kg – 88 lbs
Weight	15,0 Kg – 33,1 lbs
Bowl diameter	Flat base
Fluid control	Continuous
Counterbalance	Continuous
Pan range	360°
Tilt range	+/- 90°
Temperature range	-40°/+60° -40°/+140°F

5. Maintenance

When needed, with indoor use just clean the Head and Tripod with a soft cloth. Dirt accumulated during storage may be removed using a brush or Air spray.

CARTONI products main mechanisms are sealed as they are also built for professional outdoor use.

However, use under rough conditions they will require special care. Salt water is very corrosive and can cause extreme damages. In attempt to avoid further damage the Fluid Head should be washed off with fresh water at the earliest opportunity and perfectly dried before storage.

Sand and dirt are abrasive and should be removed using a semi-stiff brush or Air spray.

Disconnect the illuminated display & bubble level battery during long term storage; for battery replacement access the battery compartment (18).

6. Warranty

All CARTONI Fluid Heads & Pedestals have a free of charge three (3) year warranty. Register your product at www.cartoni.com within 30 days from date of first purchase/invoice to receive further two (2) year warranty for the unsurpassed free five (5) year warranty.

Tripods, spreaders, dollies and all accessories are guaranteed one (1) year from the date of first purchase/invoice.

CARTONI warrant that the product supplied will - under proper use - be free from defects in workmanship and materials and agrees that it will, at its option, either repair or replace any defective part within duration of warranty from date of first purchase with no labour charge.

This warranty does not apply to any CARTONI product that has been damaged in shipping or handling, abused, misused, operated contrary to instructions for use, neglected, normal wear or tear, modified or changed in design or construction or serviced by unauthorized parties.

Repairs or misuse by any unauthorized parties will void this warranty.

Warranty claims must be submitted – in writing - to the factory for verification or to an authorized distributor/dealer designated by CARTONI.

It is the end user's responsibility when ordering to ensure that the products ordered conform to his requirements.

All freight of product to CARTONI must be prepaid. All implied warranties are limited to the time period set forth herein & subject to change without notice.

No liability can be accepted for any variation.

7. Accessories & product line

For the complete Accessories list & Product line please visit CARTONI's official website [**www.cartoni.com**](http://www.cartoni.com).

Every product has an updated list of compatible items sorted by groups, with descriptions and technical data.